



Model: W-9060

Professional Lug Wrench

Operating Instructions and Parts Manual



This is the safety alert symbol. It is used to alert you to potential personal injury hazards. Obey all safety messages that follow this symbol to avoid possible injury or death.



WARNING

- Before using this product, read this manual and follow all its safety rules and operating instructions. When using this professional lug wrench, basic safety precautions should always be followed to reduce the risk of personal injury.

SPECIFICATION:

Material: made of heat treated, carbon steel;
Chrome plated;
Double head socket size: 11/16" and 3/4", 13/16" and 7/8";
Lever length: 15-3/4";
Adjustable lever range: 7-7/8" to 14-3/4";
Net weight: 3.04 lbs for one set;

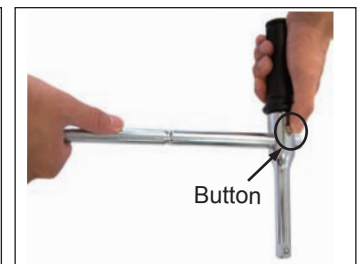
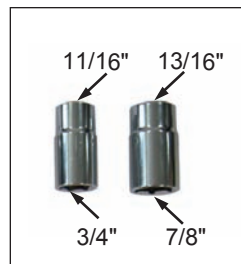
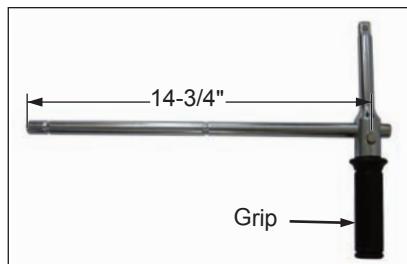
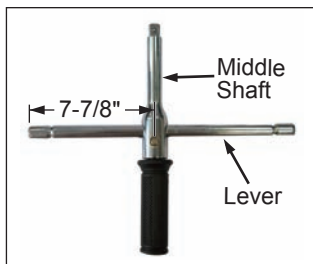

OPERATING INSTRUCTIONS

1. Press locking button on middle shaft and insert lever into hole (reference photos).
2. Release button and slide lever until it locks into desired groove at ends or in middle.
3. Lever positioned at middle, along with rotating grip, allows fast installation/removal of loosened bolts. Locking button engaged at end of Lever provides greater torquing force.
4. Install appropriate socket on square end of middle shaft.
5. Your professional lug wrench is now ready for use.

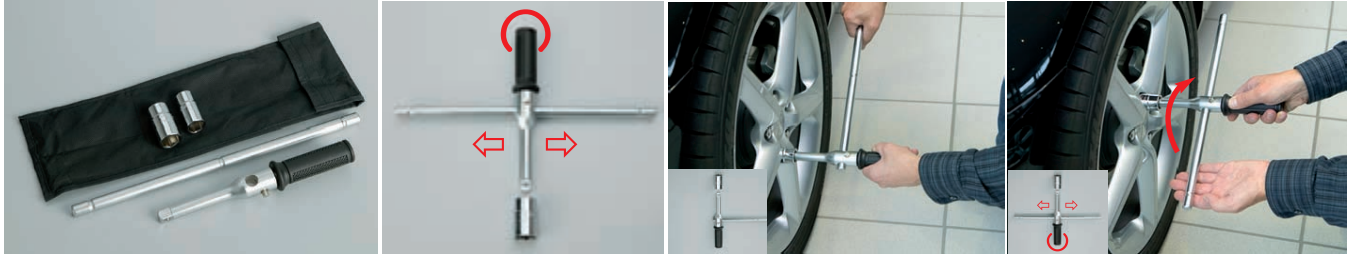

90 DAY LIMITED WARRANTY

For a period of ninety (90) days from date of purchase, MVP (H.K.) Industries Ltd. will repair or replace, at its option, without charge, any of its products which fails due to a defect in material or workmanship under normal usage. This limited warranty is a consumer's exclusive remedy.

Performance of any obligation under this warranty may be obtained by returning the warranted product, freight prepaid, to MVP (H.K.) Industries Ltd. Warranty Service Department, 10939 N. Pomona Ave., Kansas City, MO 64153.

Except where such limitations and exclusions are specifically prohibited by applicable law, (1) THE CONSUMER'S SOLE AND EXCLUSIVE REMEDY SHALL BE THE REPAIR OR REPLACEMENT OF DEFECTIVE PRODUCTS AS DESCRIBED ABOVE. (2) MVP (H.K.) INDUSTRIES LTD. SHALL NOT BE LIABLE FOR ANY CONSEQUENTIAL OR INCIDENTAL DAMAGE OR LOSS WHATSOEVER. (3) ANY IMPLIED WARRANTIES, INCLUDING WITHOUT LIMITATION THE IMPLIED WARRANTIES OF MERCHANTABILITY AND FITNESS FOR A PARTICULAR PURPOSE, SHALL BE LIMITED TO NINETY DAYS, OTHERWISE THE REPAIR, REPLACEMENT OR REFUND AS PROVIDED UNDER THIS EXPRESS LIMITED WARRANTY IS THE EXCLUSIVE REMEDY OF THE CONSUMER, AND IS PROVIDED IN LIEU OF ALL OTHER WARRANTIES, EXPRESS OR IMPLIED. (4) ANY MODIFICATION, ALTERATION, ABUSE, UNAUTHORIZED SERVICE OR ORNAMENTAL DESIGN VOIDS THIS WARRANTY AND IS NOT COVERED BY THIS WARRANTY.

Some states do not allow limitations on how long an implied warranty lasts, so the above limitation may not apply to you. Some states do not allow the exclusion or limitation of incidental or consequential damages, so the above limitation or exclusion may not apply to you. This warranty gives you specific legal rights, and you may also have other rights, which vary from state to state.



Manufactured for MVP (H.K.) INDUSTRIES LTD.
US Customer Service Agent:
10939 N. Pomona Ave. Kansas City, MO 64153